

- NOTES:
1. OVERALL SIZE AND DIMENSIONS OF PLAY AREA IS SUBJECT TO CHANGE. PROPONENT MAY CHANGE THE GENERAL SHAPE OF THE AREA, WITH THE APPROVAL OF THE CLIENT AND CONSULTANT.
 2. IF SHAPE OF PLAY AREA IS CHANGED, PROPONENT IS TO BE COGNIZANT OF EXISTING ELEMENTS.
 3. SUPPLIER FOR SHADE STRUCTURE TO ENSURE PATH OF TRAVEL IS CLEAR AND UNOBSTRUCTED FOR ALL USERS.
 4. ALL DIMENSIONS ARE SHOWN IN MILLIMETERS.

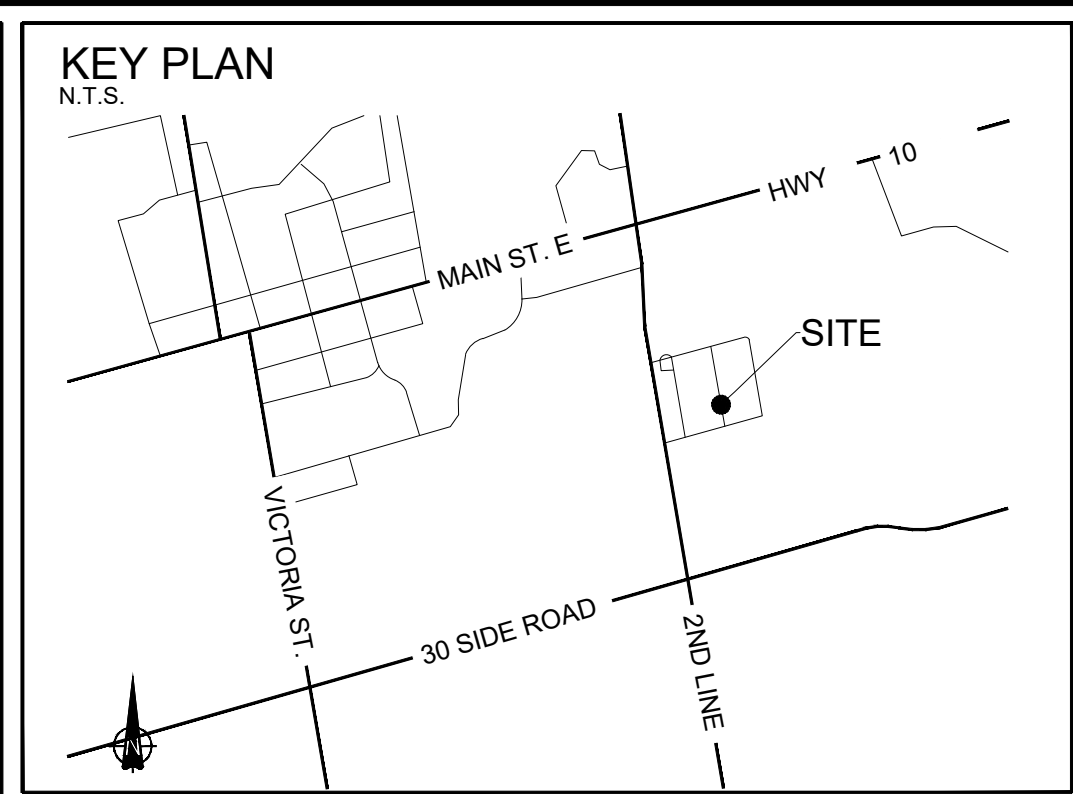

- Legend
- GENERAL NOTES:**
1. DRAWINGS NOT TO BE USED FOR CONSTRUCTION UNLESS AUTHORIZED BY THE LANDSCAPE ARCHITECT
 2. CONTRACTOR SHALL REPORT ANY DISCREPANCIES BETWEEN THE DRAWINGS AND SITE CONDITIONS PRIOR TO COMMENCEMENT OF THE WORK
 3. ALL UTILITY LOCATES ARE THE RESPONSIBILITY OF THE CONTRACTOR. HAND DIG WITHIN THE LIMITS RECOMMENDED BY THE SERVICE UTILITY. UTILITY CONFLICTS WITH PROPOSED TREE LOCATIONS MUST BE REPORTED IMMEDIATELY TO THE LANDSCAPE ARCHITECT
 4. BASE DRAWING PROVIDED BY S.Burnett Engineering.
 5. FOR GRADING INFORMATION REFER TO DRAWING BY S.Burnett Engineering. FOR SERVICING INFORMATION REFER TO DRAWINGS BY S.Burnett Engineering.
 6. LANDSCAPE DRAWINGS SHOW ENGINEERING INFORMATION FOR DESIGN PURPOSES ONLY. DO NOT CONSTRUCT ENGINEERING WORKS FROM THESE DRAWINGS.

LANDSCAPE PLAN PLAY STRUCTURE AREA

105 2nd Line
Shelburne, Ontario

ISSUED FOR PLAYGROUND
RFP, NOT FOR
CONSTRUCTION.

DATE **ISSUE** **BY**

Oct. 09, 2024	Issued for Grant Application	JH
Mar. 20, 2025	Issued for Coordination	MC
April 24, 2025	Issued for Playground RFP	MC

GSP group

201-72 Victoria Street South
Kitchener, Ontario N2G 4Y5
T: 519 588 8882
F: 519 588 8843

102 Locke Street South, Suite 200
Hamilton, Ontario L8P 4A9
T: 905 512 1417

www.gspgroup.ca

Date: 2024-10-07
Scale: 1:100

Drawn By: EM
Project No.: 15017.222

L1.2